

APPLY LUBRICANT TO ALL SEALS  
PRIOR TO INSTALLATION.  
DO NOT USE SILICONE TYPE LUBRICANTS.  
FOR PROPER ARM MOUNTING SEE IS1505.

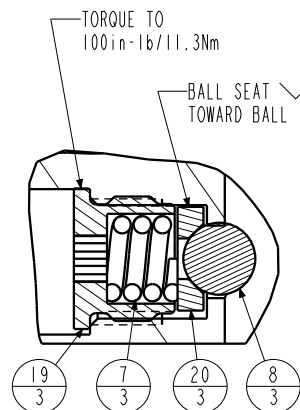

DETAIL A  
SCALE 1.500

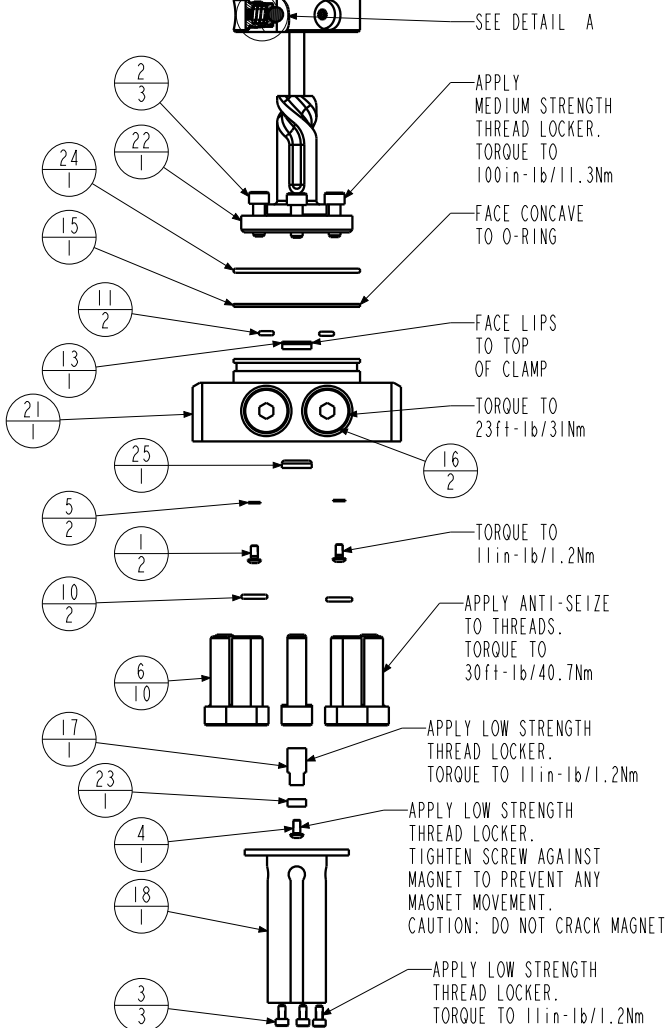
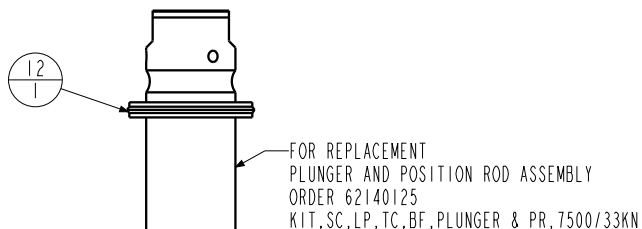

| N/A | N/A | IS1505   | INSTRUCTION SHEET, ARM INSTALLATION |               |              |
|-----|-----|----------|-------------------------------------|---------------|--------------|
| N/A | N/A | N/A      | SPRING KIT                          |               |              |
| N/A | N/A | 6V711050 | SEAL KIT, FKM                       |               |              |
| N/A | N/A | 60711050 | SEAL KIT, STANDARD                  |               |              |
| 26  | 1   | 39V11051 | WIPER, PRESS-IN, (1-1/2)            | X             | X            |
| 25  | 1   | 39V10029 | WIPER, PRESS-IN, (1/4)              | X             | X            |
| 24  | 1   | 39H51002 | O-RING, (-033)                      | X             | 39V51002     |
| 23  | 1   | 91100001 | MAGNET, .130 x .312, PS             |               |              |
| 22  | 1   | 81592132 | CAM, SC, LP, 7500/33KN, LH, TC, PR  |               |              |
| 21  | 1   | 81542112 | BASE, SC, BF, LP, 33KN, PR          |               |              |
| 20  | 3   | 81532108 | SEAT, BALL, SC, LP, TC              |               |              |
| 19  | 3   | 81532107 | RETAINER, SC, LP, TC                |               |              |
| 18  | 1   | 81500061 | HOUSING, PS, MAG, SC, LP            |               |              |
| 17  | 1   | 81500060 | ADAPTOR, PS, MAG, SC, LP            |               |              |
| 16  | 2   | 43068006 | PLUG, 1/4 BSPP MALE                 |               |              |
| 15  | 1   | 39054017 | BU RING, (-033)                     | X             | 39054023     |
| 14  | 1   | 39054016 | BU RING, (1.5x.125x.063)            | X             | X            |
| 13  | 1   | 39052043 | SEAL, LL, (1/4 X 1/8 X 1/8 X 1/2)   | X             | 39V52043     |
| 12  | 1   | 39052030 | SEAL, CROWN, 1-3/4x2-1/8x1/4        | X             | 39V52030     |
| 11  | 2   | 39051041 | O-RING, (-006)                      | X             | 39V51041     |
| 10  | 2   | 39050042 | O-RING, (-011)                      | X             | 39051025     |
| 9   | 1   | 39011075 | SEAL, LL, (1-1/2 X 1/8 X 1/8 1-3/4) | X             | 39V11075     |
| 8   | 3   | 23650004 | BALL, TUNGSTEN-CARBIDE. 250         |               |              |
| 7   | 3   | 23350066 | SPRING, COMPRESSION                 |               |              |
| 6   | 10  | 21500305 | SHCS, M8 X 1.25-6G X 30MM           |               |              |
| 5   | 2   | 21500200 | WASHER                              |               |              |
| 4   | 1   | 21500044 | SCREW, CAP, BTNH, M3-0.5 X 6, SSTL  |               |              |
| 3   | 3   | 21500043 | SHCS, M3-0.5 X 6 ALY                |               |              |
| 2   | 3   | 21500031 | SHCS, M5 X 0.8 X 14, ALY            |               |              |
| 1   | 2   | 21500019 | SCREW, CAP, BTNH, M3 X 6, ALY       |               |              |
| No. | QTY | PART No. | DESCRIPTION                         | Std. Seal Kit | FKM Seal Kit |

### PARTS LIST



VEKTEK, INC.  
1334 E. SIXTH AVE. P.O. BOX 625  
EMPORIA, KS. 66801 U.S.A.

#### ASSEMBLIES AFFECTED

41423322PS

41423322PSF

#### PARTS LIST, ASSY, SC, LP, TC, BF, 33KN, DA, LH, PS

SIZE A MPL7231

REV C

SHEET 1 OF 1

|         |                        |  |            |          |
|---------|------------------------|--|------------|----------|
| C       | 5762                   | RELEASE                                      | JDW        | 07/18/25 |
| REV     | IN ACCORDANCE WITH ECN | EFFECTIVE DATE                               | REVISED BY | DATE     |
| DRW BY: | JDW                    | DRAWING STATUS: <b>Released</b>              |            |          |
| DATE:   | 10/16/13               | PRODUCTION APPROVED FOR RELEASED STATUS ONLY |            |          |

